

Flansch-Rückschlagventil

Art. 01-707

PN10/16

flange check valve

DIN 86262

Gehäuse: Rotguss (2.1096 / CC491K)

Innenteile: Rotguss

Sitzdichtung: metallisch

Temperaturbereich: -10°C - 225°C

Body: gunmetal

Inner parts: gunmetal

Seat sealing: metallic

temperature range: -10°C - 225°C

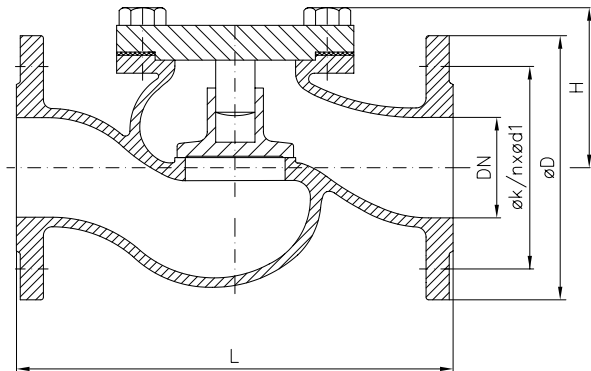

| DN | L | H | øD | øk | n x ød1 | kg | | | | | | |
|-----|-----|-----|-----|-----|---------|-------|--|--|--|--|--|--|
| 15 | 130 | 70 | 95 | 65 | 4 x 14 | 3,5 | | | | | | |
| 20 | 150 | 70 | 105 | 75 | 4 x 14 | 4,0 | | | | | | |
| 25 | 160 | 75 | 115 | 85 | 4 x 14 | 5,0 | | | | | | |
| 32 | 180 | 80 | 140 | 100 | 4 x 18 | 6,0 | | | | | | |
| 40 | 200 | 90 | 150 | 110 | 4 x 18 | 8,5 | | | | | | |
| 50 | 230 | 100 | 165 | 125 | 4 x 18 | 11,0 | | | | | | |
| 65 | 290 | 110 | 185 | 145 | 4 x 18 | 15,0 | | | | | | |
| 80 | 310 | 130 | 200 | 160 | 8 x 18 | 20,0 | | | | | | |
| 100 | 350 | 150 | 220 | 180 | 8 x 18 | 25,0 | | | | | | |
| 125 | 400 | 170 | 250 | 210 | 8 x 18 | 40,0 | | | | | | |
| 150 | 480 | 190 | 285 | 240 | 8 x 22 | 55,0 | | | | | | |
| 200 | 600 | 230 | 340 | 295 | 8 x 22 | 95,0 | | | | | | |
| 250 | 730 | 280 | 395 | 350 | 12 x 22 | 140,0 | | | | | | |
| 300 | 850 | 330 | 445 | 400 | 12 x 22 | 250,0 | | | | | | |

Andere Ausführung:

Art.-Nr. 01-707F mit Feder

Auf Anfrage auch mit Rotguss-Innenteilen

und/oder in Eckform erhältlich.

other type:

art.-no. 01-707F spring loaded

inner parts bronze and/or angle type on

request.

Alle Angaben sind unverbindlich und bleiben technischen Änderungen vorbehalten.
All data are not binding and subjected to change without notice.



Fritz Barthel Armaturen GmbH & Co. KG

Schnackenburgallee 16
22525 Hamburg (Germany)

Phone +49 (0) 40 398202-0
Fax +49 (0) 40 398202-77

E-Mail post@barthel-armaturen.de
Internet www.barthel-armaturen.de

06.2010